

FR REAR HUB

Free Hub Body Installation

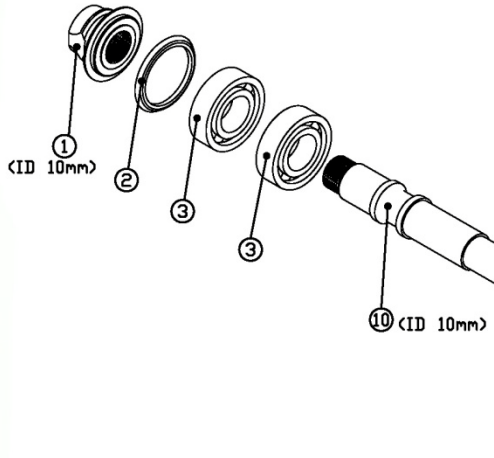
- Remove the drive side end cap by using two 15mm cone wrenches, one on each end cap. If the non-drive side end cap loosens first, remove the drive side end cap by clamping the exposed non-drive side axle using a good quality axle vice. Be sure not to damage axle threads by using the appropriately sized clamp. We recommend the use of a Park Tool AV4 Axle Vise. There is a picture of a Park Tool AV4 in this document for your reference (Fig. 6).
- **NOTE:** If you have an early model hub with an axle that has slotted ends, **DO NOT USE** the slots to remove the end caps. Use only an axle vise.
- See Figures 3 and 4 for 3D exploded diagrams of FR Rear Hubs.
- Slide the free hub body complete with spring, pawls and seals off of the axle.
- Lightly grease the ratchet teeth surface on the new free hub body assembly with quality bearing grease. Ritchey Bearing Grease, or Phil Wood Waterproof Grease is a good example.
- Be sure that all axle bearing surfaces are clean and dry before installing the new free hub body. Reinstall the free hub body, and end caps. End cap torque specification: drive side: 100kgf; non-drive side: 110kgf . You may reference hub model exploded drawing in this document for correct assembly. Be sure that all seals and dust caps are in their correct position, and there is no undue resistance when turning the axle and free hub body.



www.syncros.com

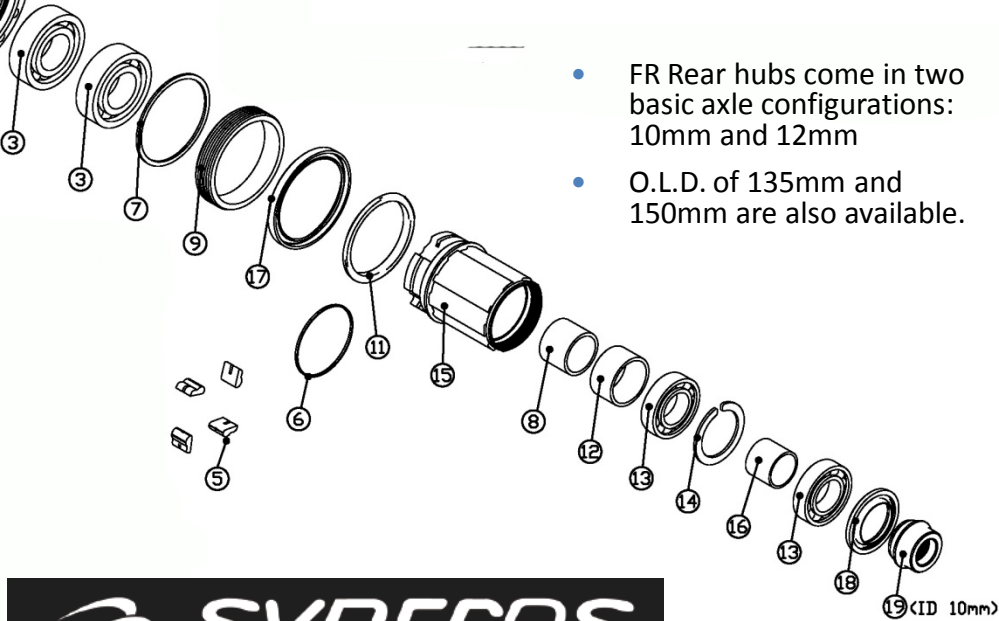


Fig.3 FR Rear Hub (10mm I.D.)



- FR Rear hubs come in two basic axle configurations: 10mm and 12mm
- O.L.D. of 135mm and 150mm are also available.

<u>Part No.</u>	<u>Description</u>
1	Left End cap
2	Left side seal
3	Qty 4 Bearings 6003
4	Hub Shell
5	4 Pawls
6	Pawl Spring
7	Spacer
8	Freehub Bearing Spacer
9	Ratchet Ring (not removable)
10	7075 Axle, Hollow, 10mm ID
11	Freehub Cap (inside)
12,13,14,15	Freehub Body Assembly
16,17,18	
19	Right End Cap



FR Hubs: Supplementary Information



FIG. 6 These photos show the correct use of the Park Tool Axle Vise to remove axle end caps. This tool, or a tool like it, is essential to service the hubs correctly. Make sure to use the center clamp for the inner axles when removing the end

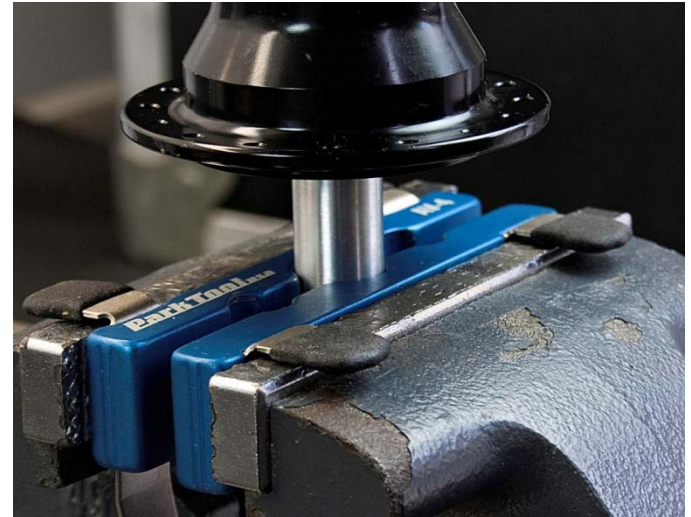


Fig. 5 A tool we recommend



- The Wheels Mfg Wizard Bearing Press



FR Hubs: Supplementary Information



This shows the FR Front 20mm X 110mm axle hub with the adaptor kit for a 9mm QR X 100mm.



FR rear hub
pawl spring
orientation



This is the FR rear hub ratchet system shown with freehub and freehub seal removed.

